

## C: Using print layouts in QGIS

a560

### Enhancing maps with print layouts

Can add legends, text, and other information

Construct but dragging, dropping, and modifying map elements.

### Example: population by zip code in Central New York

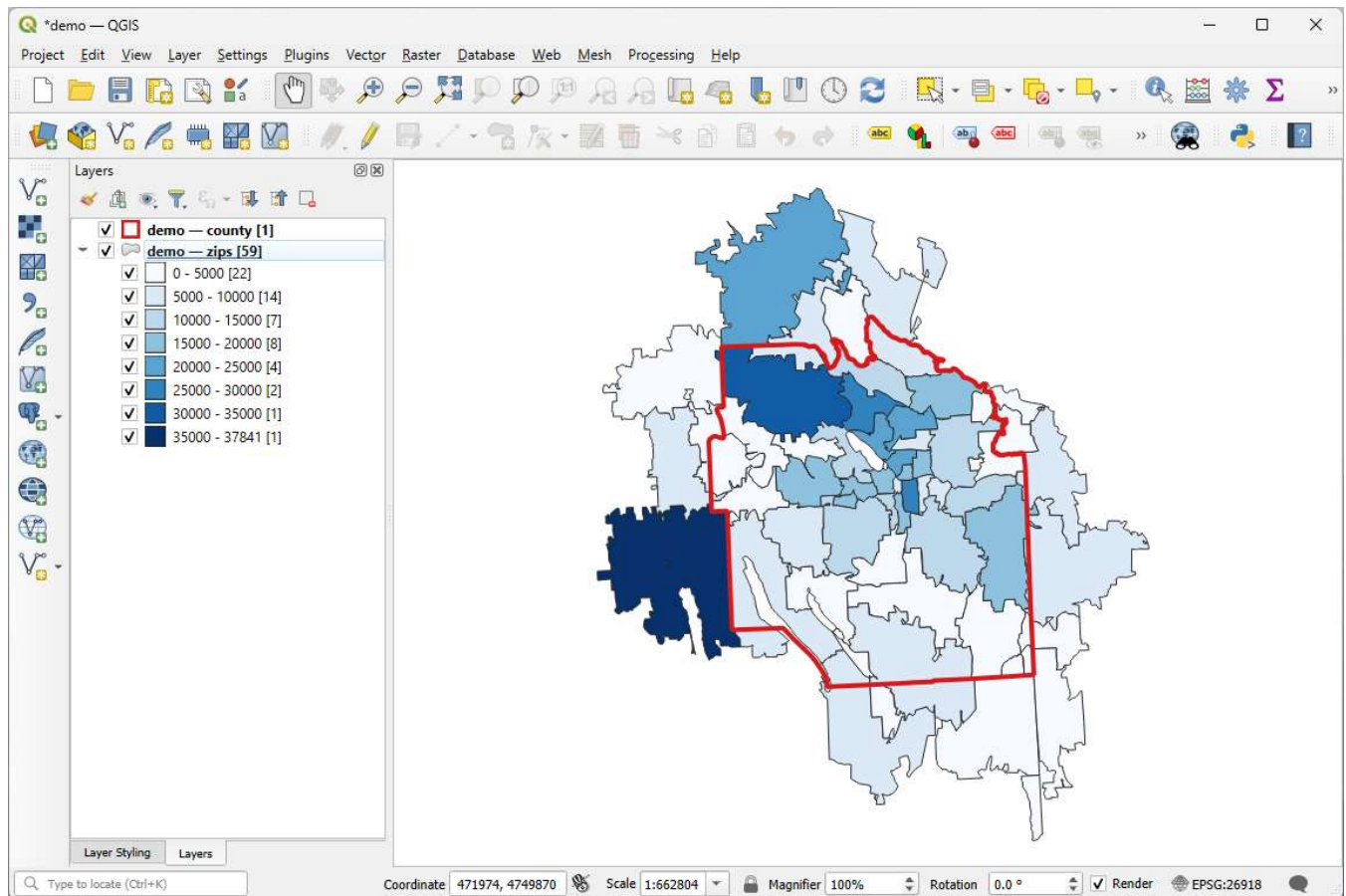

### Building a print layout with a legend and title:

Create a new print layout:

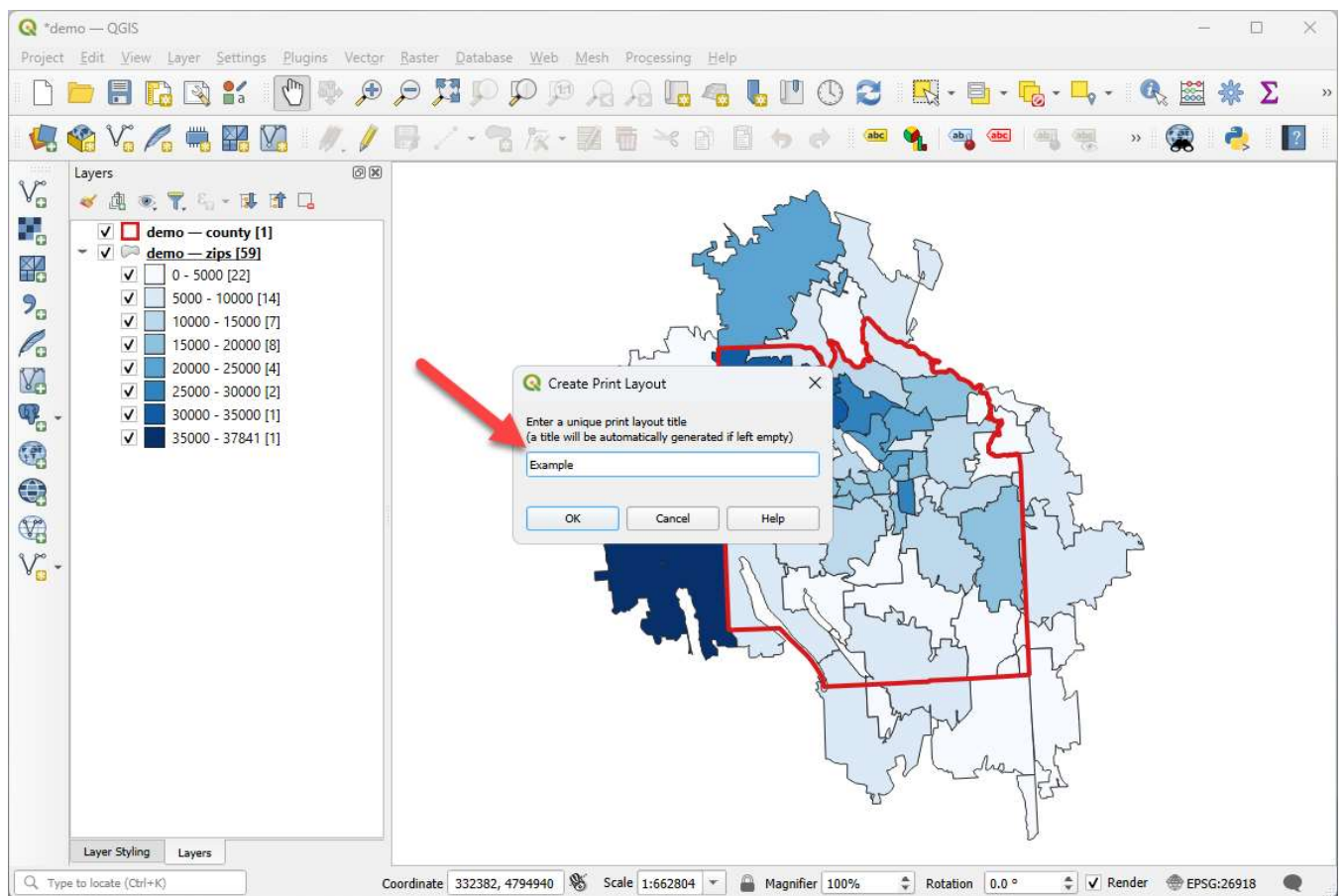
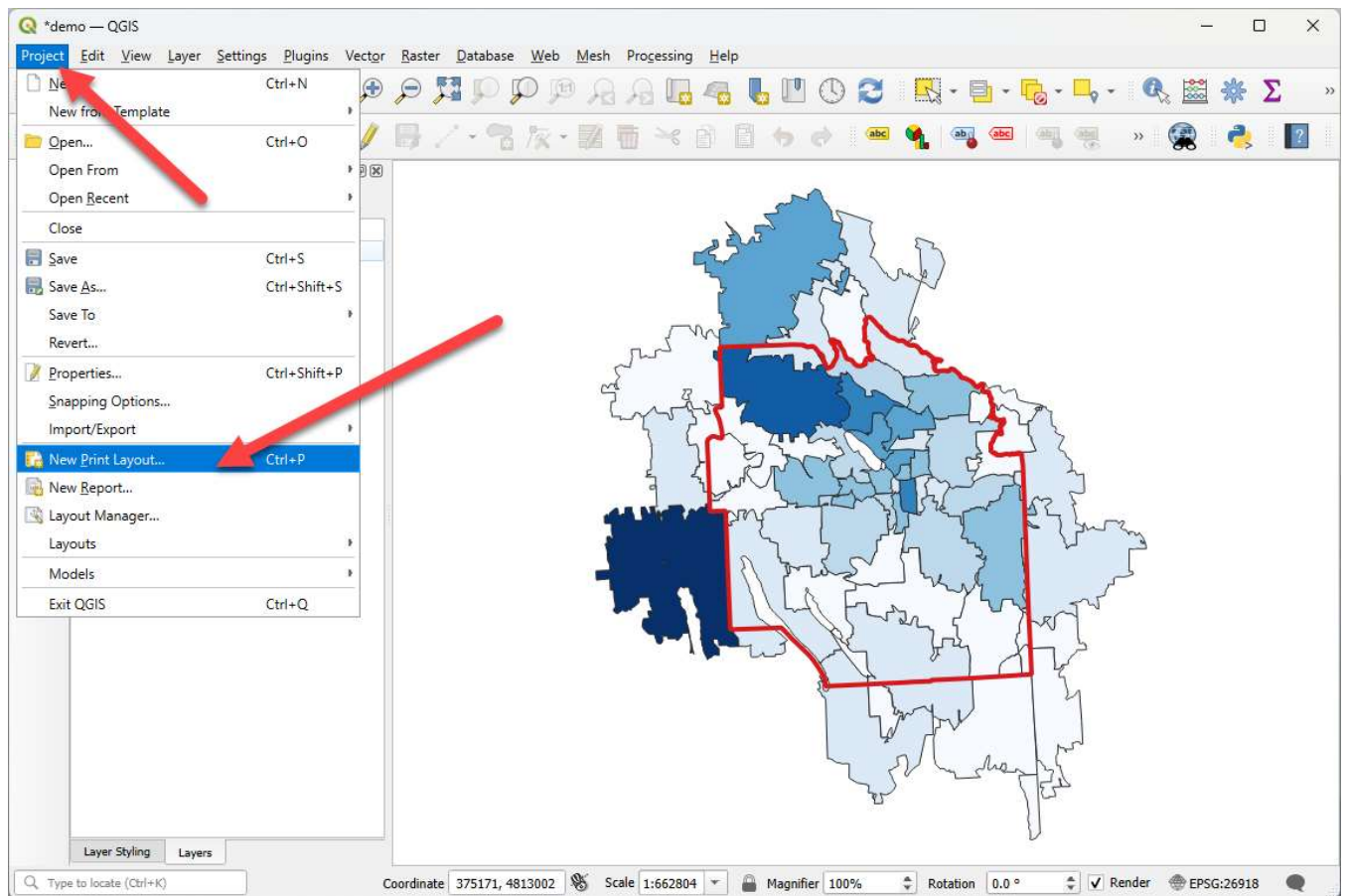

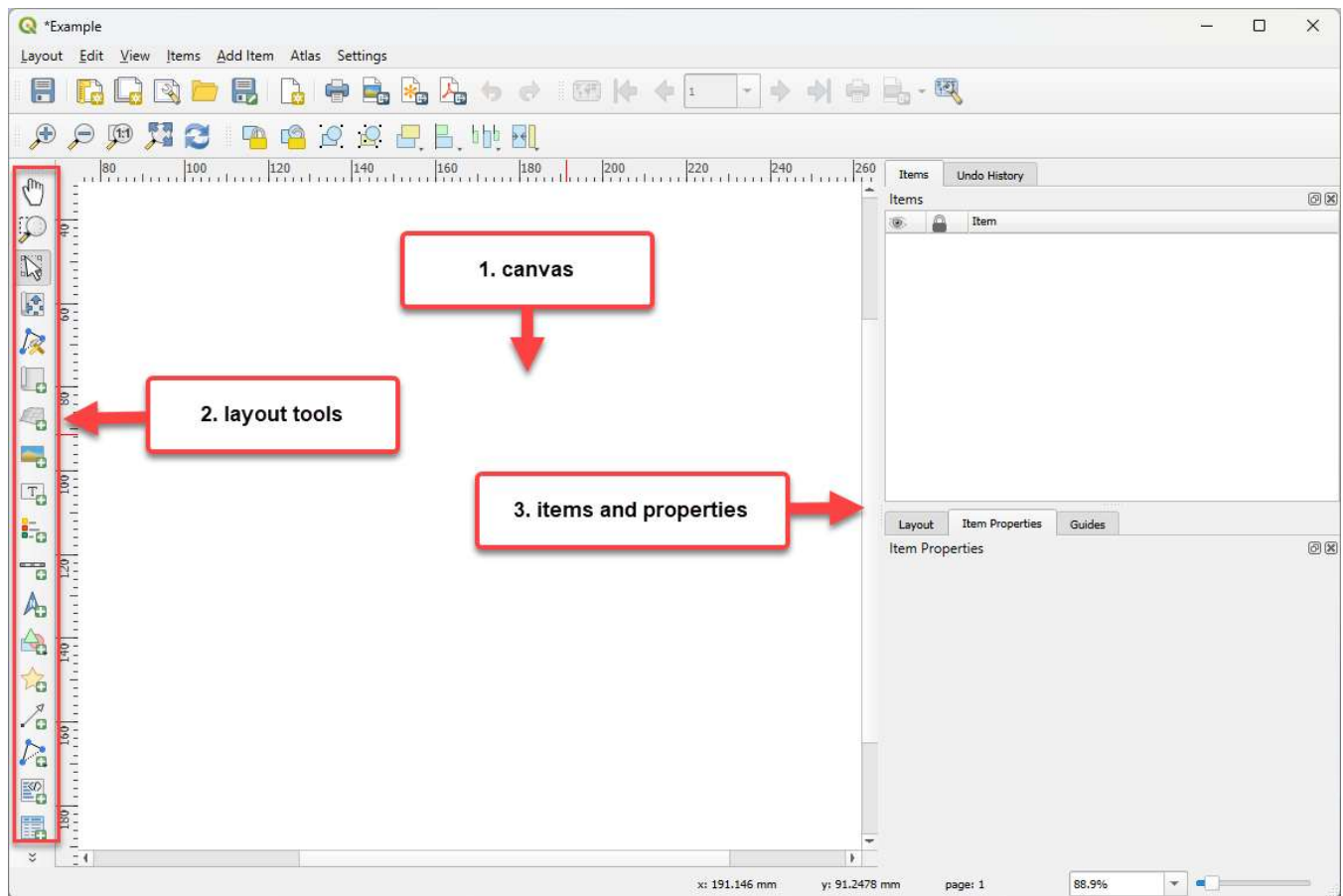

## Adding a map:

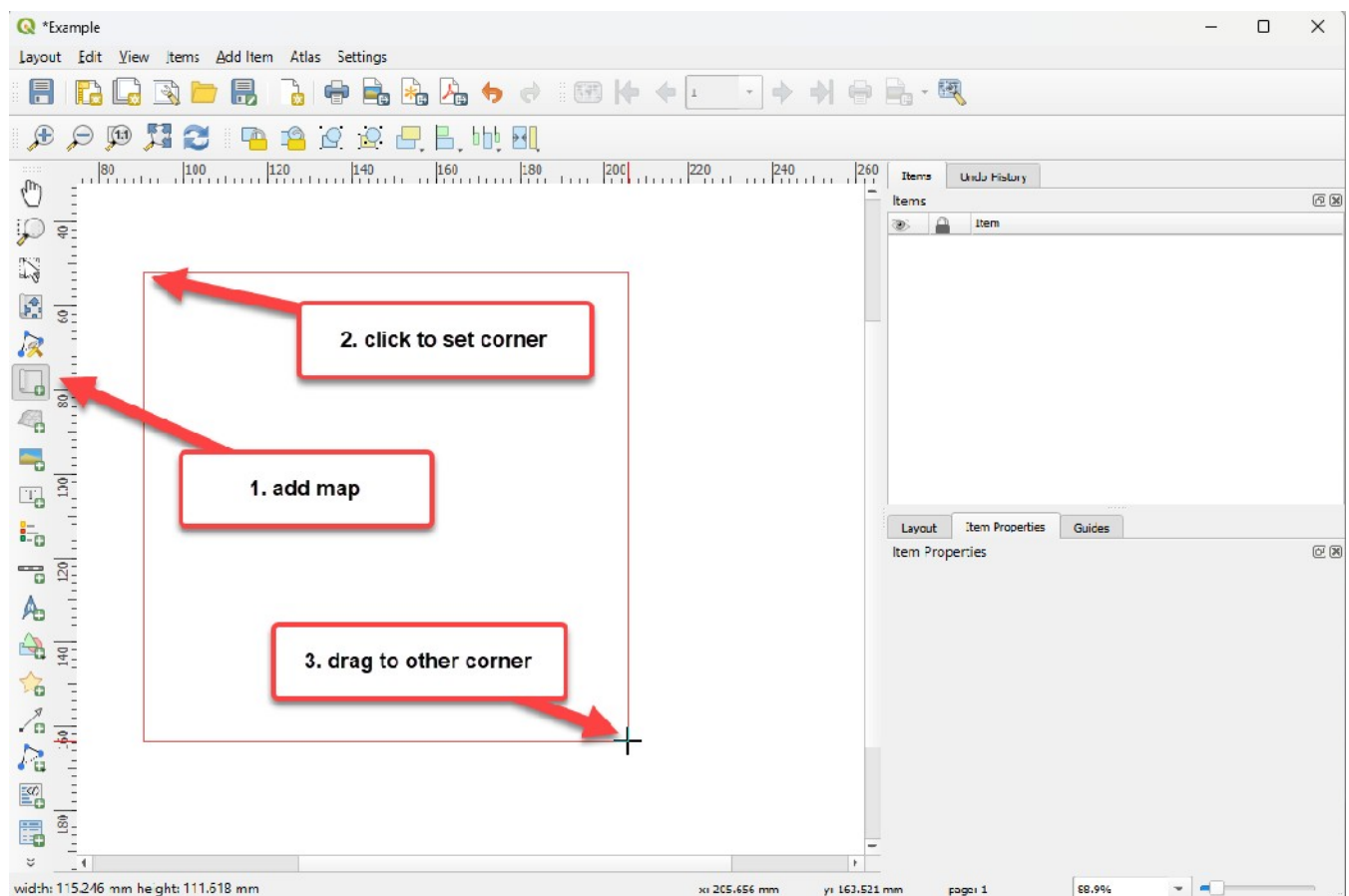

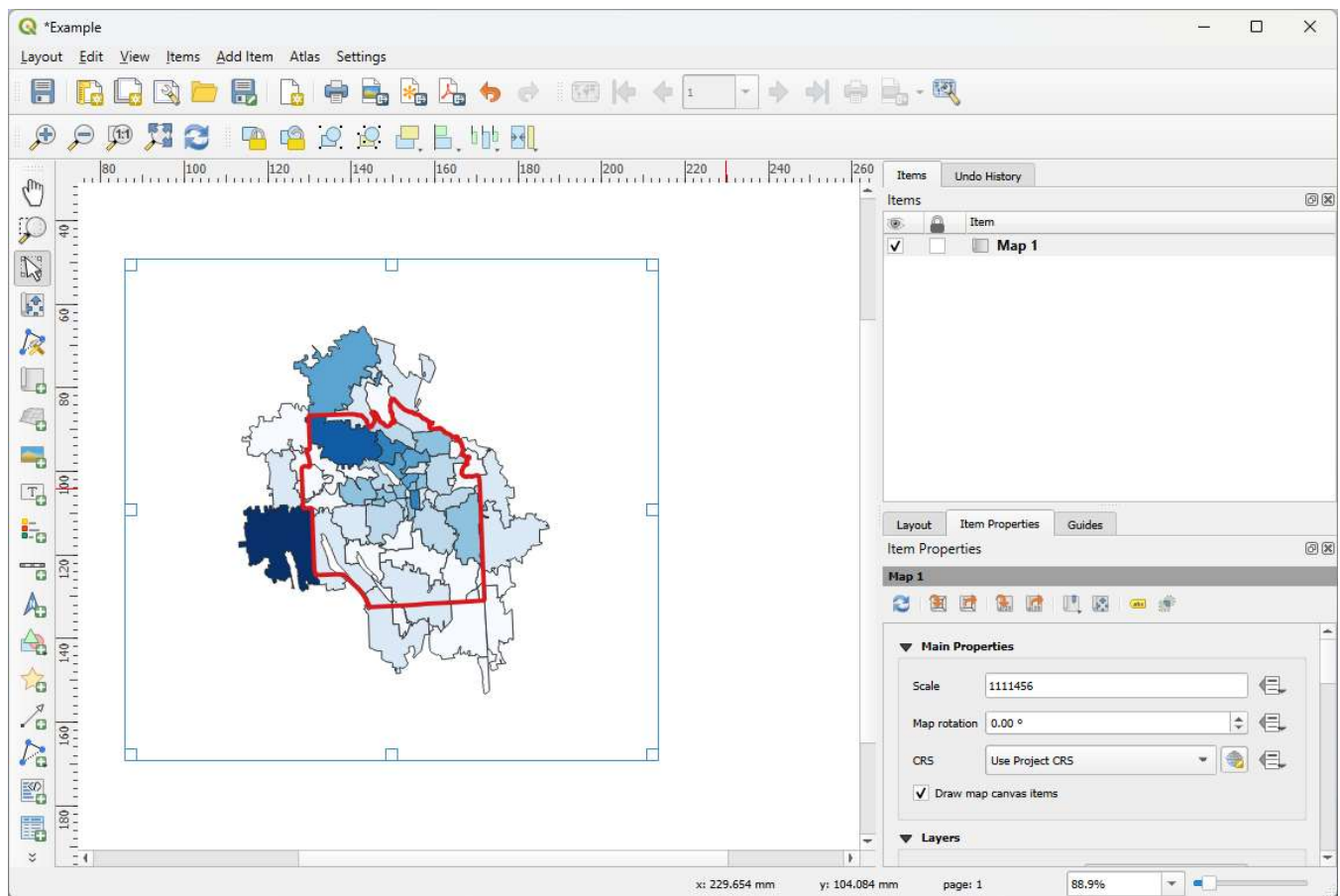

Adding a legend:



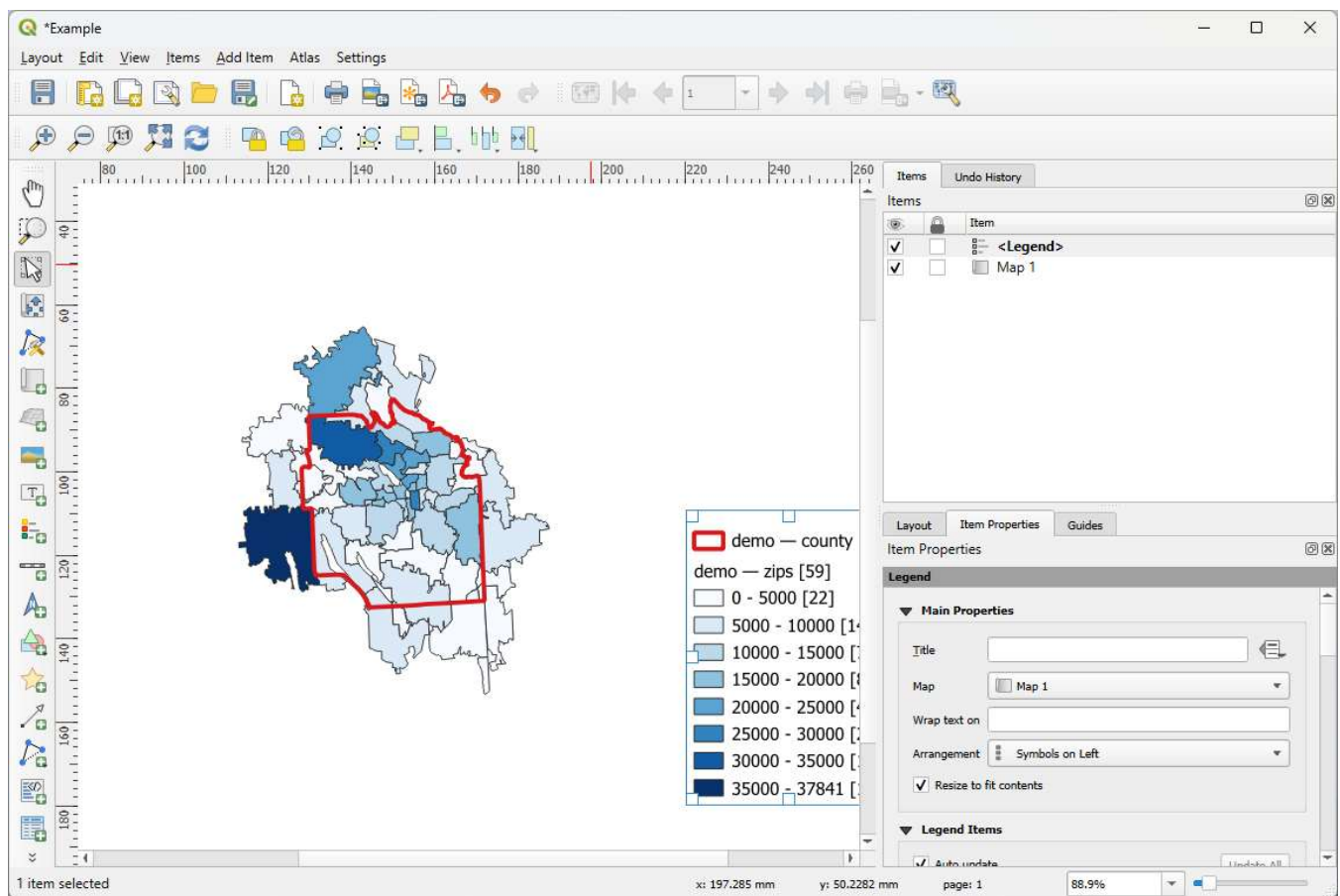
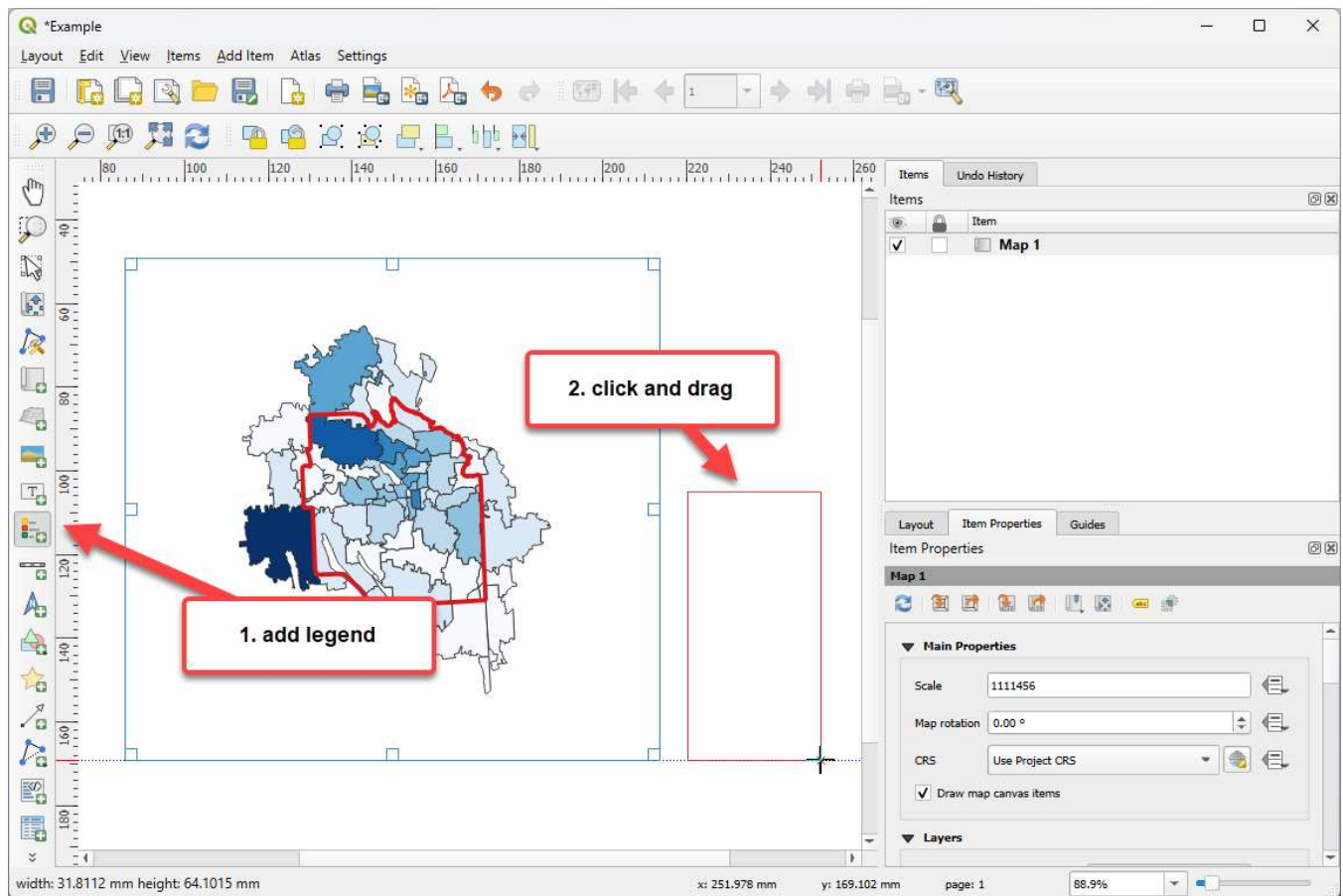

## Removing a legend entry:

1. select legend

2. select county boundary

3. remove from legend

demo — county [1]  
demo — zips [59]  
0 - 5000 [22]  
5000 - 10000 [14]  
10000 - 15000 [7]  
30000 - 35000 [1]  
35000 - 37841 [1]

Remove selected item(s) from legend

## Replacing the text of an entry:

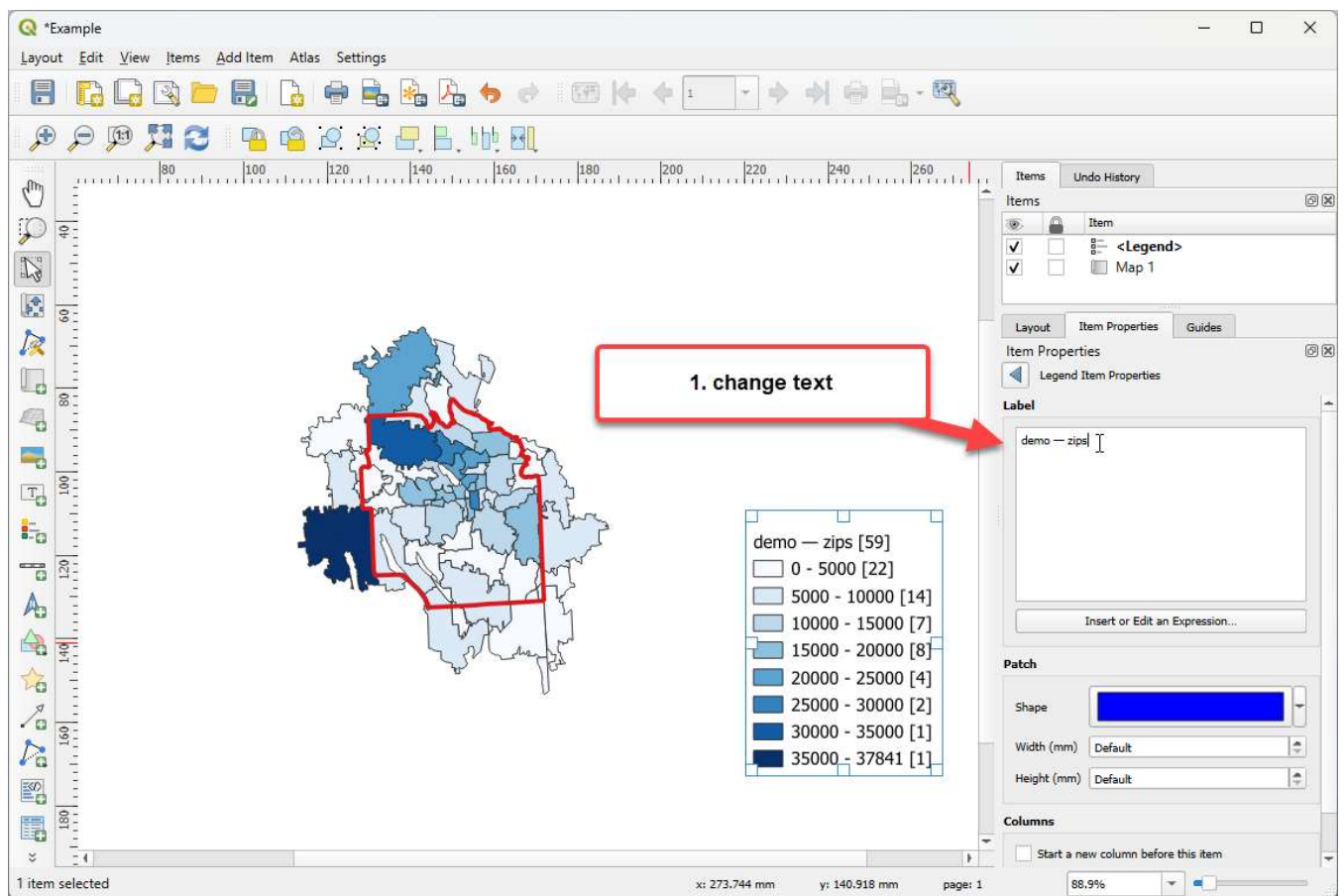
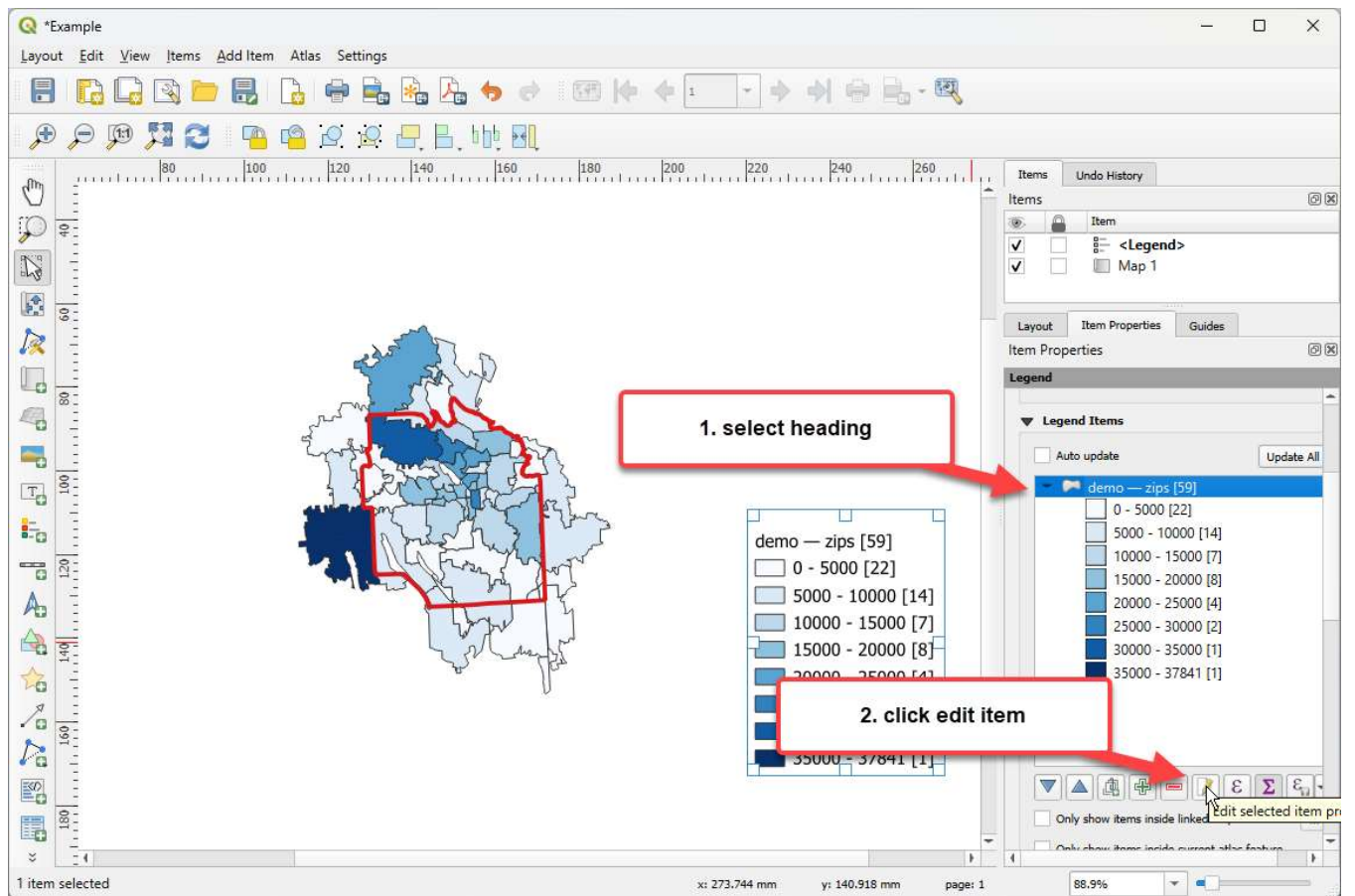



## Changing the font size:

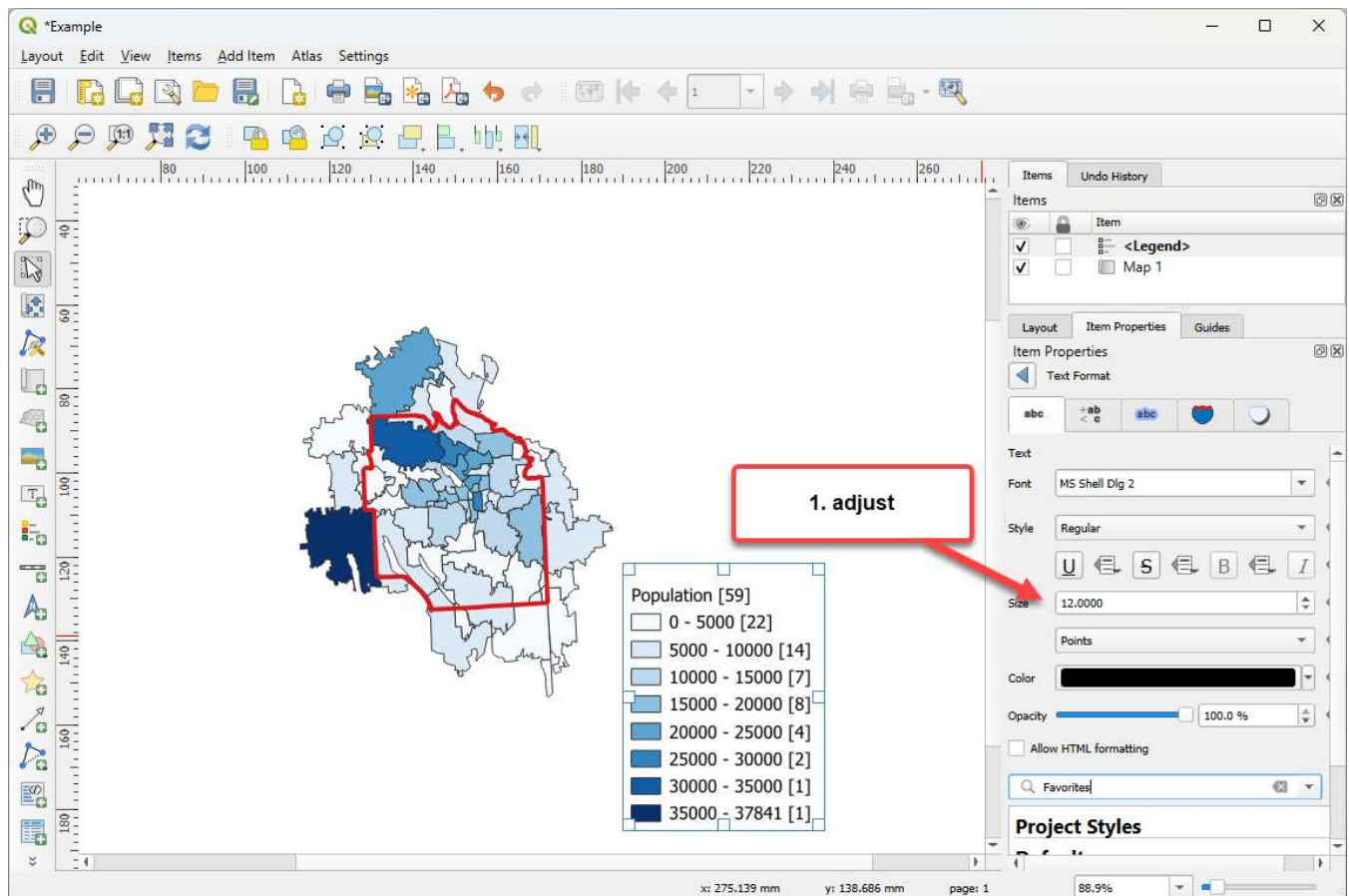
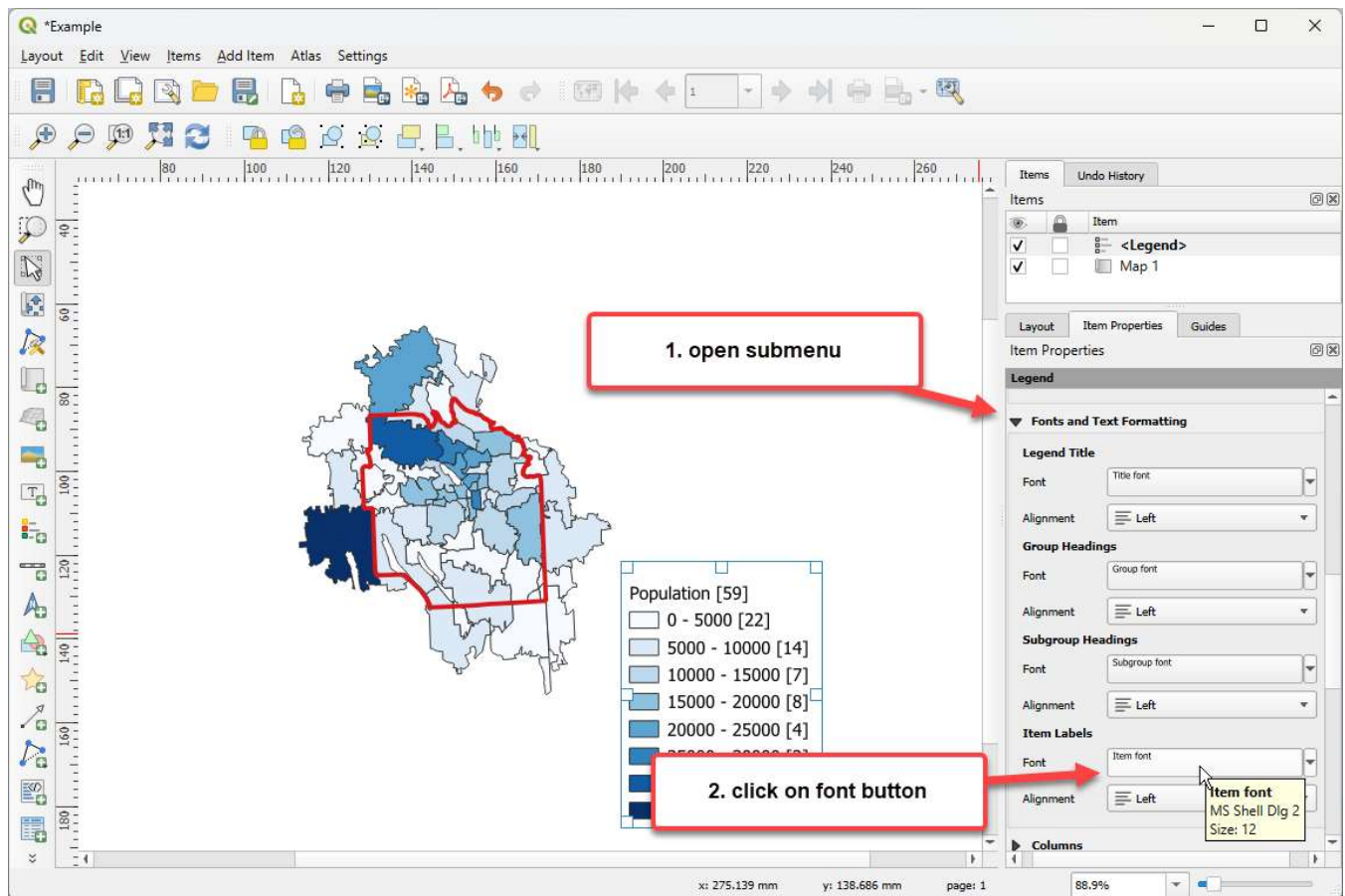



## Adjusting overall layout:

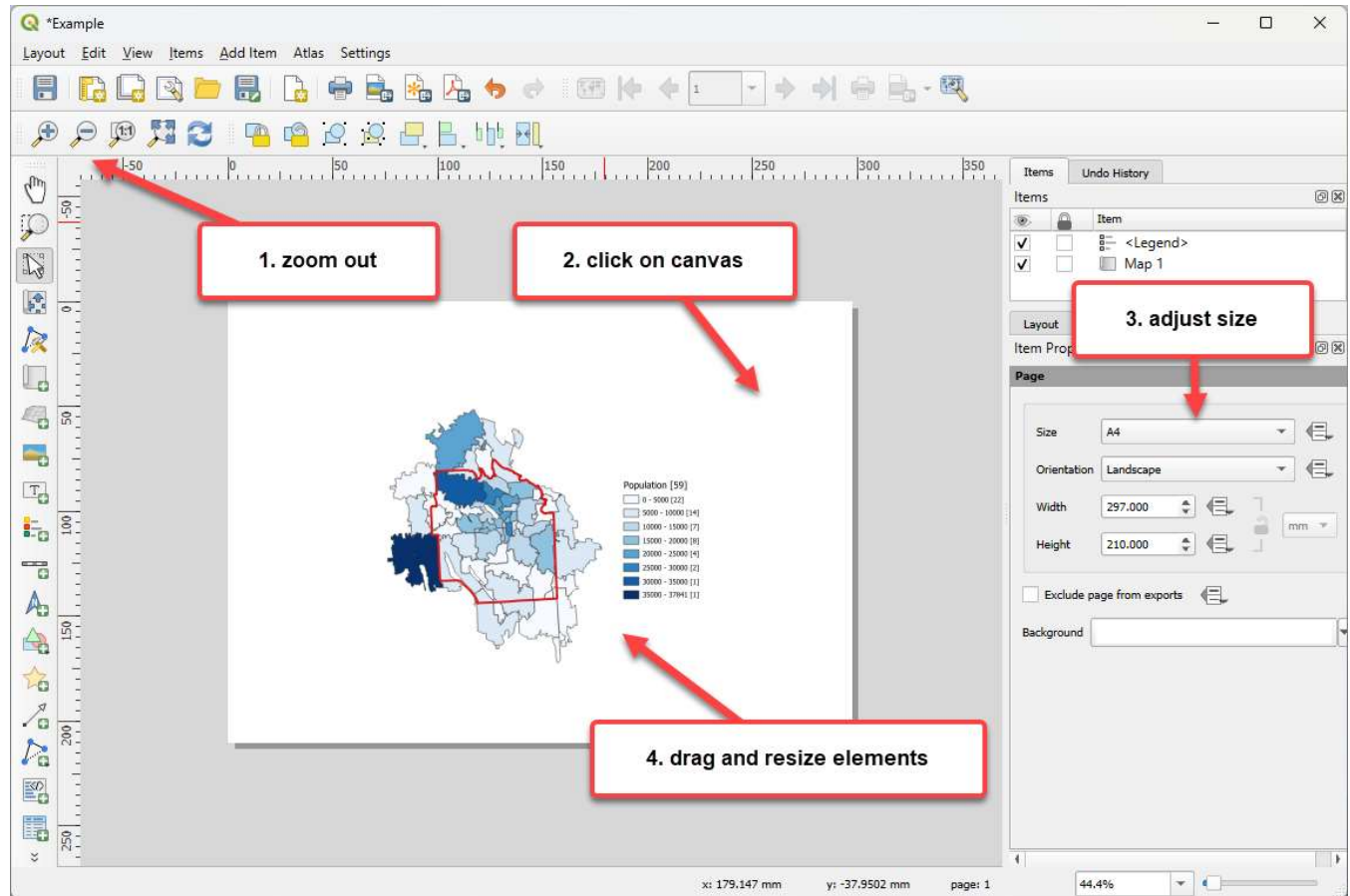

## Adding a title:

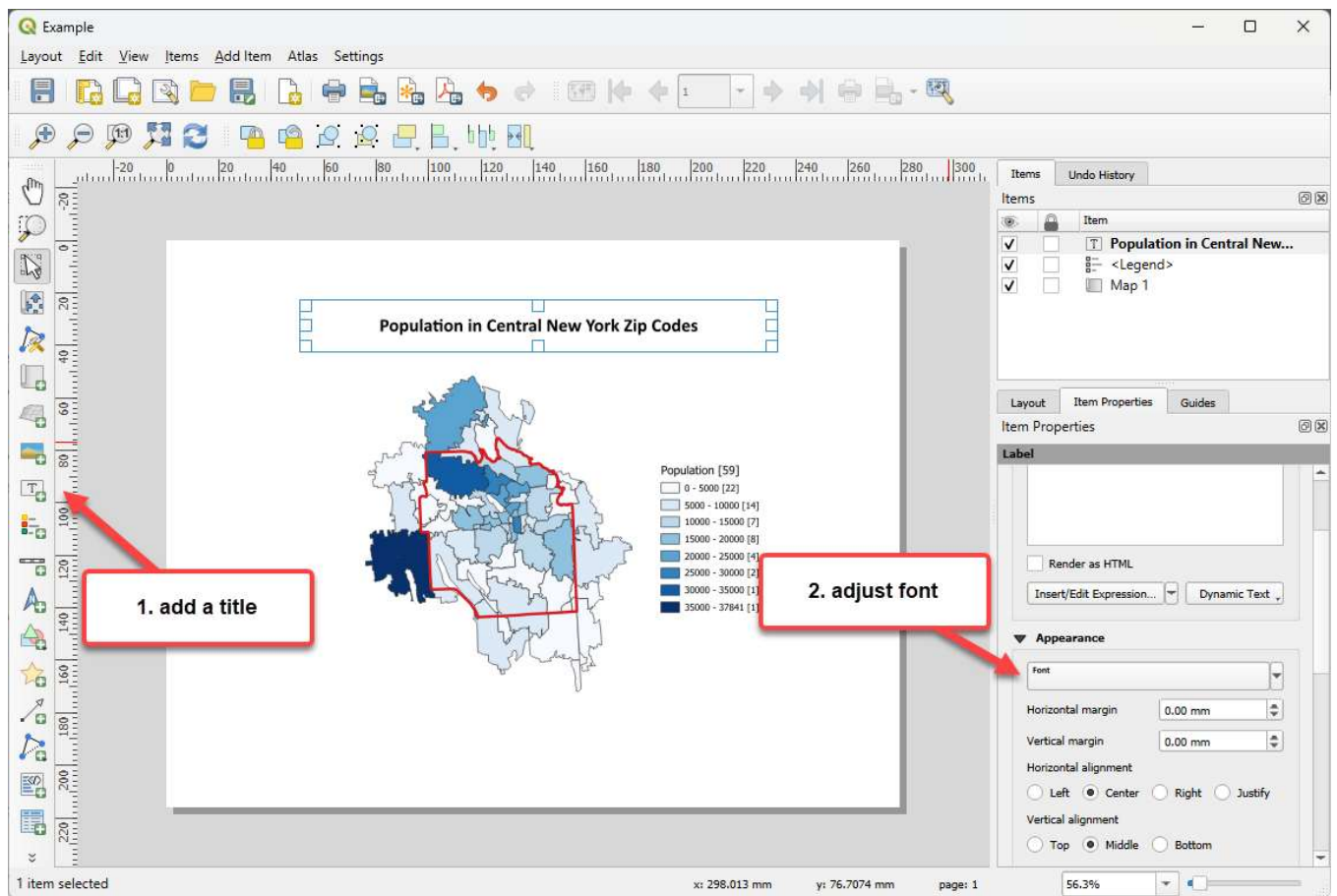

Saving as an image:

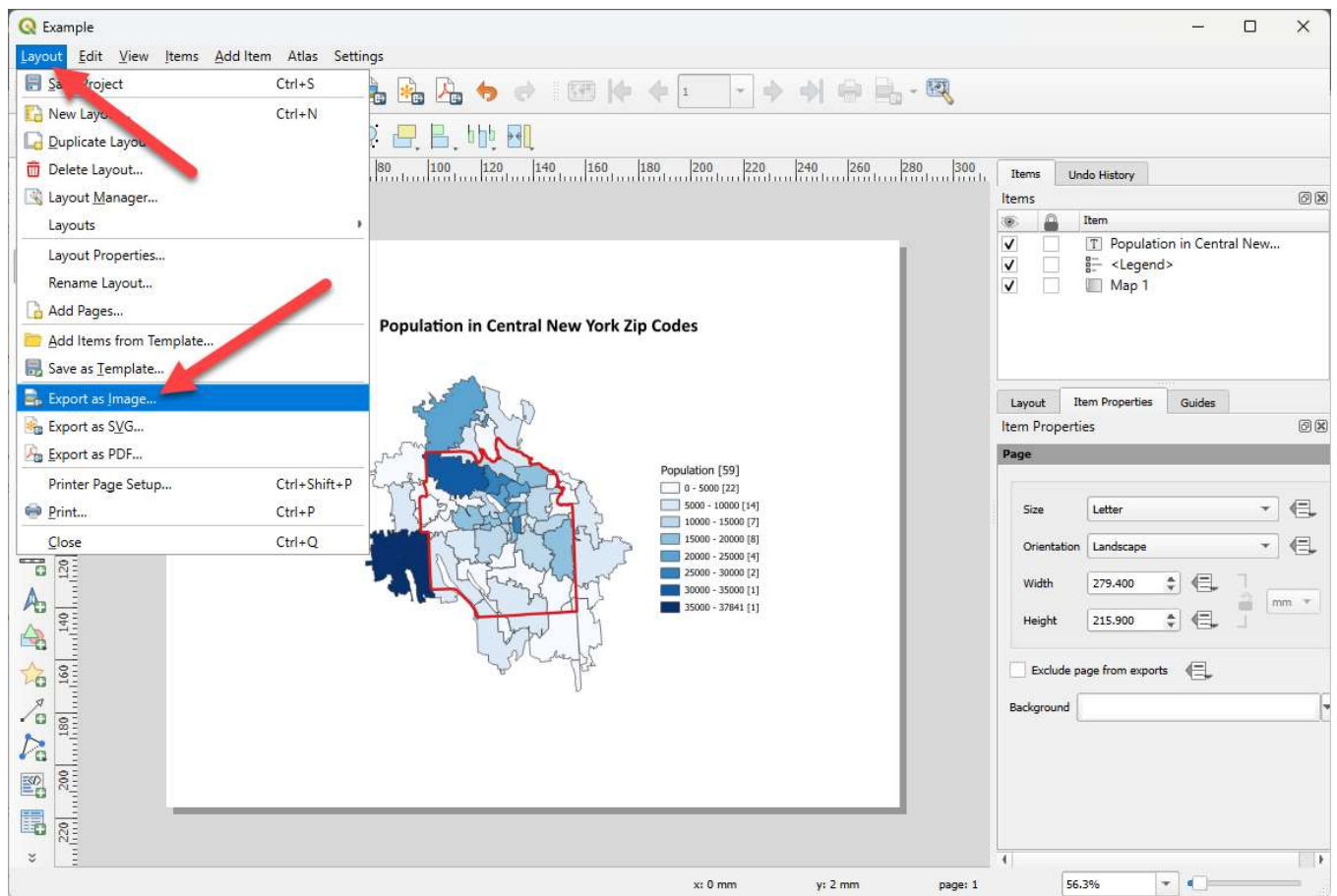

Finished result:

## Population in Central New York Zip Codes

